

Lancaster County Comprehensive Juvenile Justice Study
Lincoln, Nebraska

Contact: Mr. Michelle Schindler, Director
Youth Services Center
1200 Radcliff Street
Lincoln, NE 68512
Email: mschindler@lancaster.ne.gov
(402) 441-7093

Project Started October 1997
Project Completed June 1999
Construction Completed February 2002

Due to overcrowding in secure detention, the Lancaster County Commissioners initiated a comprehensive study of juvenile justice. The first phase of the project involved the completion of a needs assessment study. The study findings indicated a heavy use of secure detention for both pre- and post-adjudicated youth, and a secure detention rate that was higher than comparison counties. The study recommendations called for expansion of the continuum of services for youthful offenders, including pre-trial diversion, home detention, tracker services, day reporting, and non-secure detention. In addition, new detention capacity was recommended to meet the long-term needs of Lancaster County.



Phase I- Needs Assessment

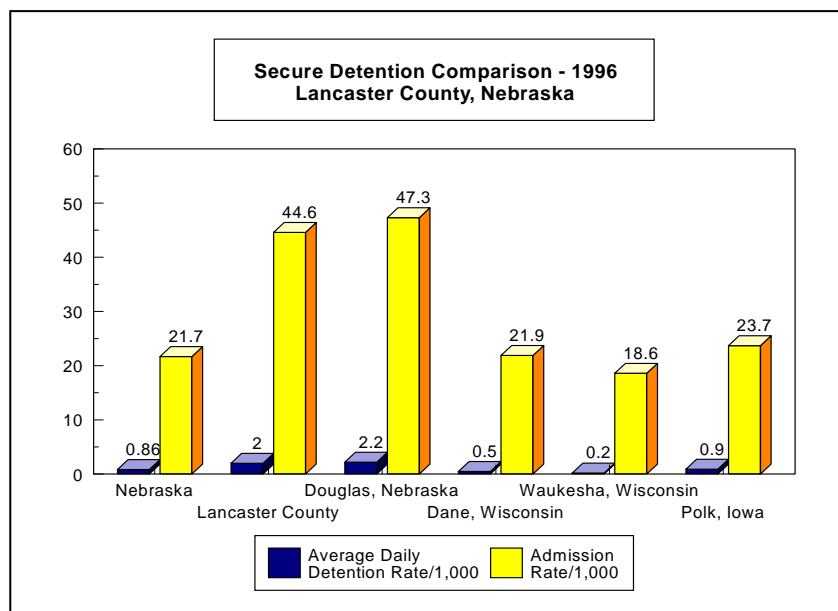

Based on the recommendations presented in the needs assessment, Lancaster County initiated the second phase of the study process. Phase II involved the completion of a detailed operational and architectural program for a 60 bed secure detention facility, and 20 beds of non-secure detention capacity. In addition to developing the operational and capital cost of the detention facility, the operational and capital costs to implement other programmatic alternatives to detention were developed.

Phase II - Operational and Architectural Program

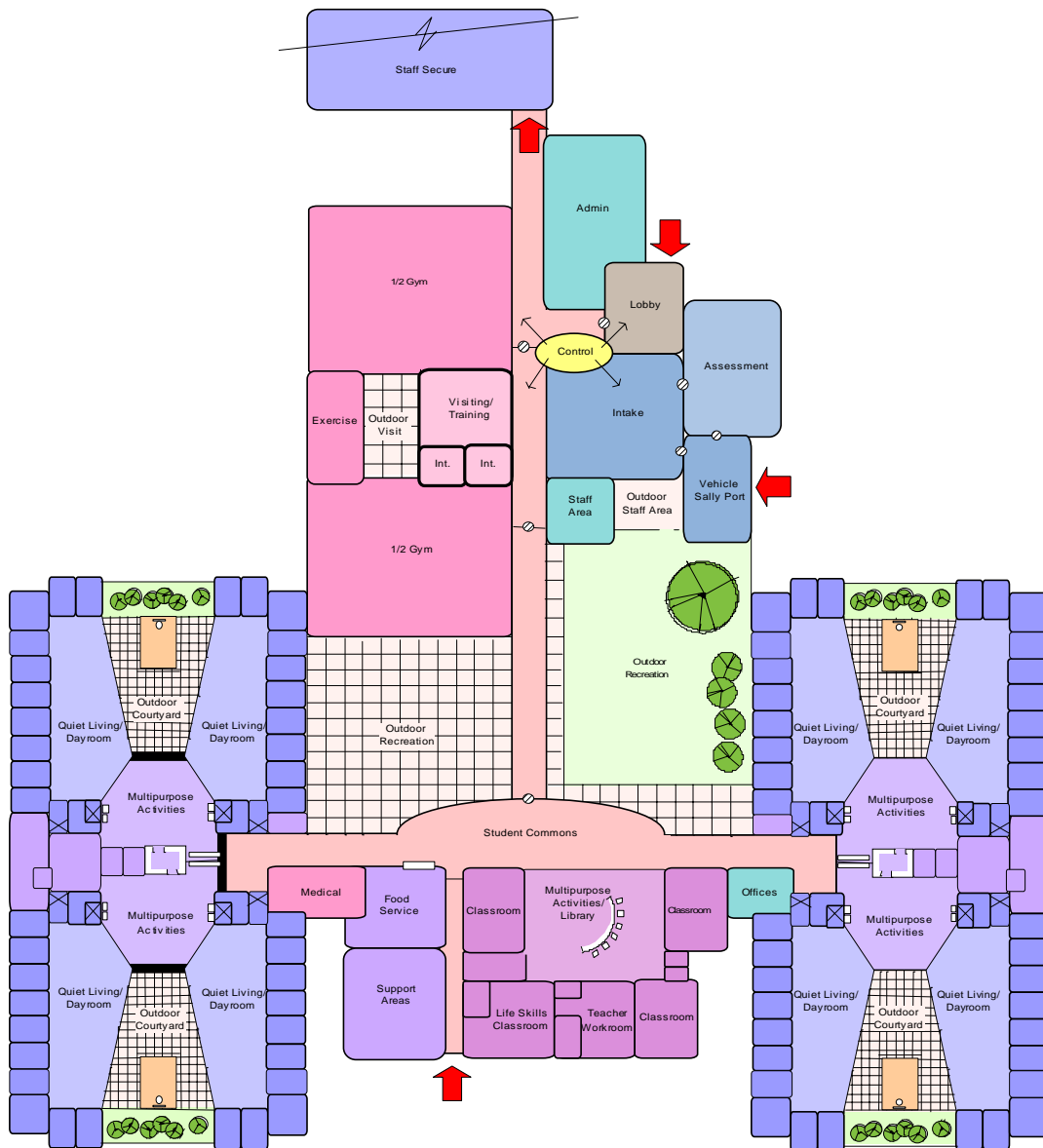

Lancaster County Youth Center
Site Diagram