

Lancaster County, Nebraska - Pre-Architectural Corrections Planning Services
Lincoln, Nebraska

Contact: Mr. Mike Thurber, Director
Lancaster Co. Corrections Dept.
Lincoln, NE 68508
(402) 441-8922
Email: mthurber@lancaster.ne.gov

Mr. Al Povondra, Architect
Carlson West Povondra Architect
Lincoln, NE 68508
(402) 551-1500 Office
Email: apovondra@cwpaarchitects.com

Project Completed: December 2006

In early 2006, Lancaster County hired the Consulting Team of the Clark Enersen Partners, Carlson West Povondra Architects, and Chinn Planning, Inc. to prepare a Pre-Architectural Jail Study. The County was faced with an expanding inmate population, and was housing inmates out of county due to lack of space in existing jail facilities in the County. Chinn Planning, Inc. developed forecasts of the future inmate population, analyzed operational efficiencies in the existing jail facilities, and developed an operational and architectural space program for an 800 bed jail facility to meet the twenty year inmate projection. Based on the operational and space program for the 800 bed jail facility completed by Chinn Planning, Inc., the Consultant team developed operational and cost estimates for renovation/expansion of existing facilities and compared that to costs for construction and operation of a new jail.

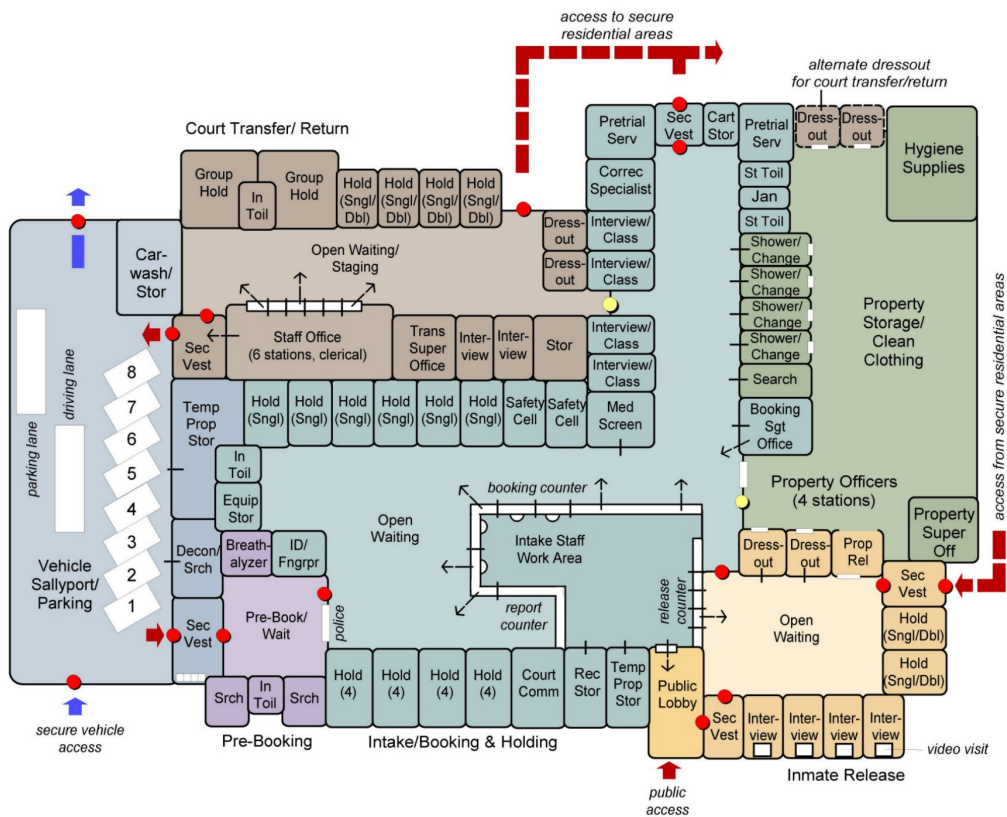

Lancaster County Intake, Release & Transfer Diagram

- secure access control
- secondary access control