

**California Department of Corrections and Rehabilitation Conceptual Program
Plan for Secure Reentry Facility
Sacramento, California**

Contact: Mr. Art Lytle, Senior Project Manager
Kitchell
Sacramento, CA 95833
(916) 648-9700
Email: alytle@kitchell.com

Mr. Armand Burrue, California Dept. of Corrections and Rehabilitation
Division of Reentry and Recidivism Reduction
Sacramento, CA 95814
(916) 323-6117
Email: armand.burrue@cdcr.ca.gov

Project Completed..... October 2007

In July 2007, the California Department of Corrections and Rehabilitation (CDCR) Division of Reentry and Recidivism Reduction contracted with Chinn Planning, Inc. to develop a conceptual program for a 500 Bed and a 200 Bed Secure Reentry Facility. The Division of Reentry and Recidivism Reduction is the CDCR entity responsible for working with local law enforcement and city/county elected officials in the siting of secure reentry facilities throughout California. The partnerships between CDCR and Cities or Counties will support inmates nearing their release date, and returning parolees with improved programs, services and supervision. Key elements of the secure reentry facilities will include improved offender risk and needs assessments; improved case management; improved wrap around services for the offender; continuity of support between custody and parole; and improved collaborative partnerships between corrections, law enforcement and local community service providers.

The conceptual programs developed by Chinn Planning, Inc. will be presented to local governments throughout California, to serve as a planning guide. The goal in developing the conceptual facility plans was to design a program model for evidence-based offender rehabilitation that will greatly improve the parole success of California's adult offenders.

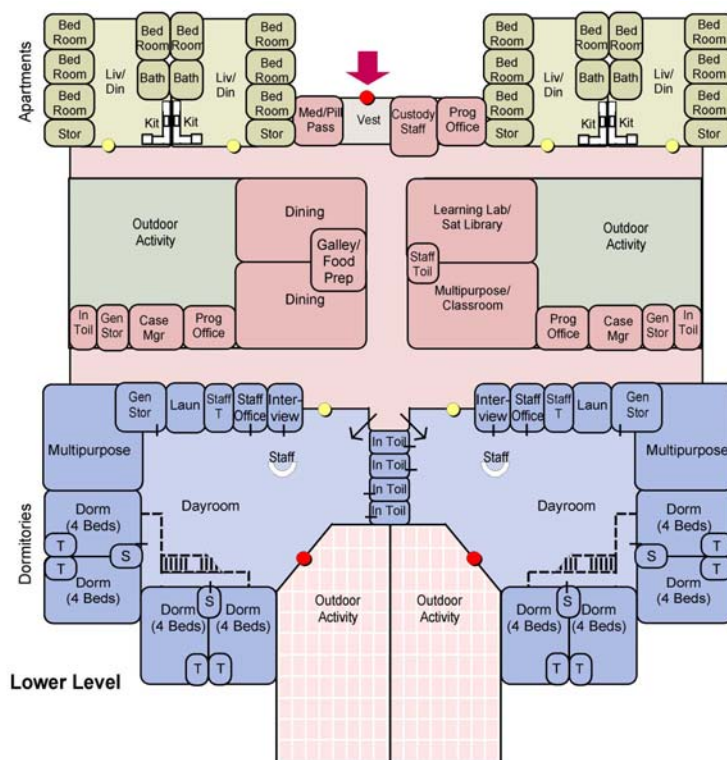

CDCR Reentry Facility
Dormitory & Apartment Housing Diagram - Option 3
96 Capacity (2 Dorm Housing Units @ 32 Beds, 8 Apartments @ 4 Beds)
● secure access control ● secondary access control